

			RE-230	RE-260	RE-300	RE-420	RE-480	RE-550	RE-620	RE-710	RE-820	RE-920	
	(50Hz)	Rpm	2950										
	(50Hz)	m ³ /h	232	266	307	417	481	554	625	712	820	924	
	VI		2.2 2.6 3.0 3.5 4.4										
		%	25, 50, 75, 100										
		%	25~100										
			3 2										
		550	Y- ,PWS, DOL						Y- , DOL				
	(50Hz)	V	380										
			F										
			PTC										
		L	14	16	16	16	17	19	23	26	28	28	
		W	300										
		Bar	32										

冷凝温度(°C)	蒸发温度(°C)	-5	0	5	10
25	制冷量(kW)	224.0	274.6	334.0	402.9
	功率(kW)	38.4	38.7	38.9	38.7
	电流(A)	67.1	67.7	67.9	67.7
30	制冷量(kW)	212.7	261.4	318.4	384.8
	功率(kW)	42.9	43.5	43.9	44.0
	电流(A)	74.2	75.1	75.7	75.9
35	制冷量(kW)	201.3	247.9	302.6	366.4
	功率(kW)	48.0	48.8	49.5	49.8
	电流(A)	82.2	83.5	84.5	85.0
40	制冷量(kW)	189.4	234.1	286.5	347.7
	功率(kW)	53.5	54.6	55.5	56.1
	电流(A)	91.0	92.8	94.3	95.2
45	制冷量(kW)	177.2	219.8	270.0	328.6
	功率(kW)	59.5	60.9	62.0	62.9
	电流(A)	100.7	103.0	104.9	106.3
50	制冷量(kW)	164.4	205.1	253.0	309.1
	功率(kW)	66.0	67.6	69.1	70.2
	电流(A)	111.3	114.1	116.5	118.3

冷凝温度(°C)	蒸发温度(°C)	-5	0	5	10
25	制冷量(kW)	250.1	306.7	373.0	450.1
	功率(kW)	42.6	43.0	43.2	43.0
	电流(A)	81.9	82.4	82.6	82.4
30	制冷量(kW)	237.5	291.8	355.5	429.7
	功率(kW)	47.7	48.4	48.8	48.9
	电流(A)	88.2	89.1	89.6	89.7
35	制冷量(kW)	224.7	276.7	337.9	409.1
	功率(kW)	53.3	54.3	55.0	55.3
	电流(A)	95.6	96.9	97.8	98.3
40	制冷量(kW)	211.5			

冷凝温度(°C)	蒸发温度(°C)	-5	0	5	10
25	制冷量(kW)	286.0	350.7	426.5	514.7
	功率(kW)	48.2	48.6	48.8	48.6
	电流(A)	88.8	89.4	89.6	89.4
30	制冷量(kW)	271.6	333.7	406.6	491.4
	功率(kW)	53.9	54.7	55.2	55.2
	电流(A)	96.4	97.4	98.1	98.2
35	制冷量(kW)	256.9	316.5	386.4	467.8
	功率(kW)	60.3	61.3	62.1	62.5
	电流(A)	105.3	106.9	108.0	108.6
40	制冷量(kW)	241.8	298.8	365.8	443.9
	功率(kW)	67.2	68.6	69.7	70.4
	电流(A)	115.6			

冷凝温度(°C)	蒸发温度(°C)	-5	0	5	10
25	制冷量(kW)	377.2	462.6	562.6	678.8
	功率(kW)	62.8	63.4	63.7	63.4
	电流(A)	107.3	108.3	108.7	108.3
30	制冷量(kW)	358.3	440.2	536.3	648.1
	功率(kW)	70.3	71.3	72.0	72.1
	电流(A)	120.1	121.8	122.8	123.0
35	制冷量(kW)	338.9	417.4	509.6	617.0
	功率(kW)	78.6	80.0	81.0	81.5
	电流(A)	134.0	136.6	138.3	139.2

冷凝温度(°C)	蒸发温度(°C)	-5	0	5	10
25	制冷量(kW)	502.4	616.1	749.5	904.4
	功率(kW)	83.5	84.7	85.1	84.4
	电流(A)	145.2	147.1	147.7	146.7
30	制冷量(kW)	477.1	586.2	714.3	863.3
	功率(kW)	93.3	95.1	96.1	95.9
	电流(A)	160.2	163.0	164.5	164.3
35	制冷量(kW)	451.2	555.8	678.7	821.8
	功率(kW)	103.8	106.2	107.7	108.0
	电流(A)	176.9	180.8	183.3	183.9
40	制冷量(kW)	424.7	524.8	642.4	779.7
	功率(kW)	114.9	117.9	120.0	120.9
	电流(A)	195.3	200.4	204.0	205.5
45	制冷量(kW)	397.2	492.9	605.4	736.9
	功率(kW)	126.7	130.3	133.1	134.5
	电流(A)	215.4	221.7	226.4	228.9
50	制冷量(kW)	368.7	459.9	567.4	693.1
	功率(kW)	139.3	143.7	147.1	149.1
	电流(A)	237.2	244.7	250.5	254.0

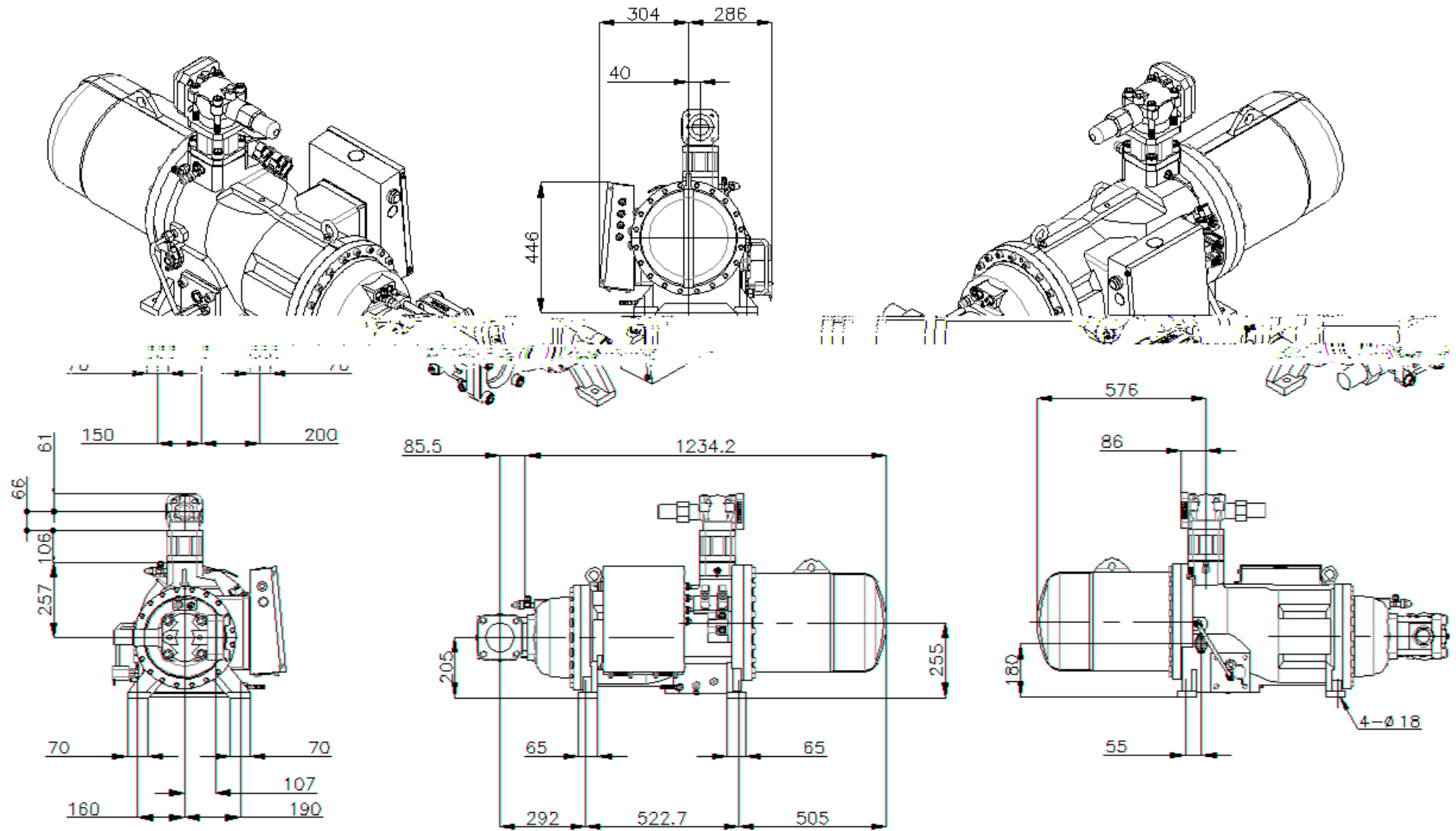

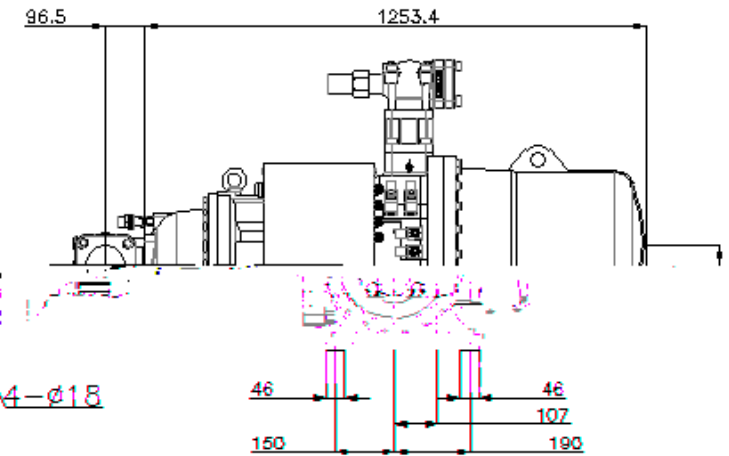
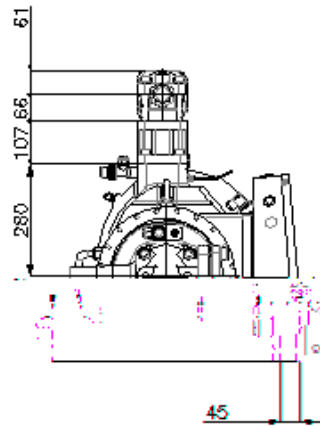
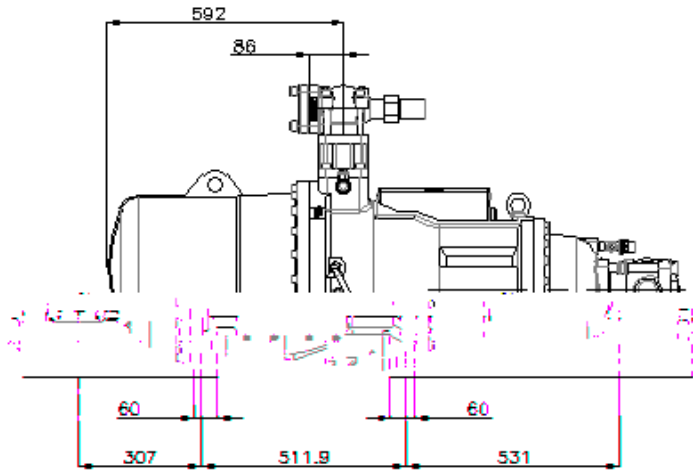
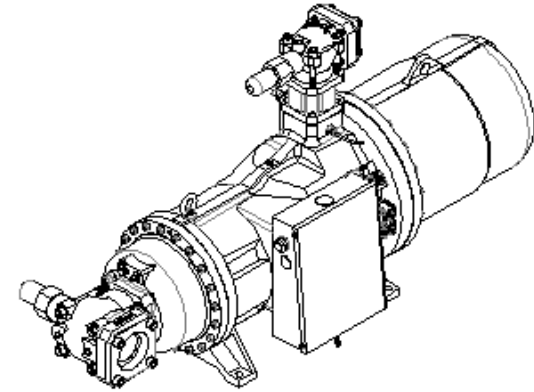
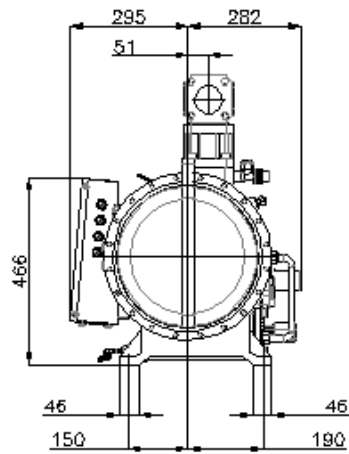
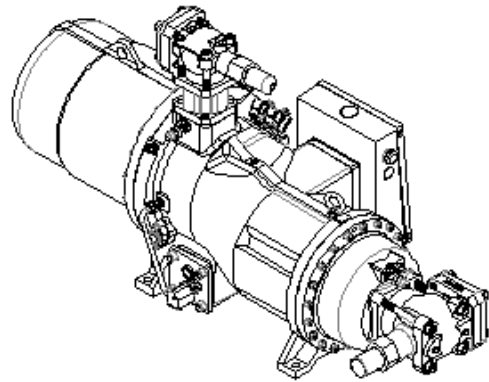

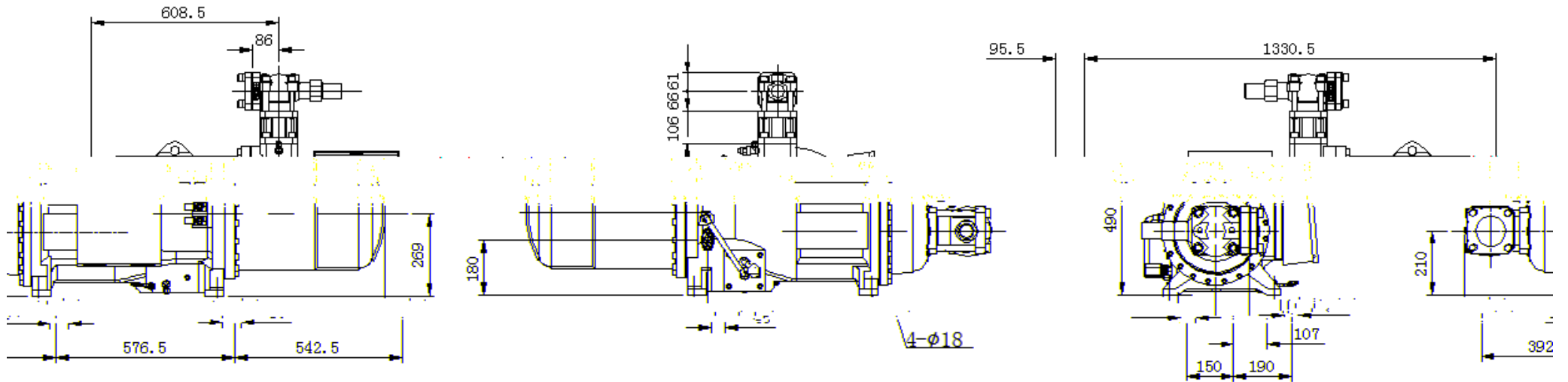
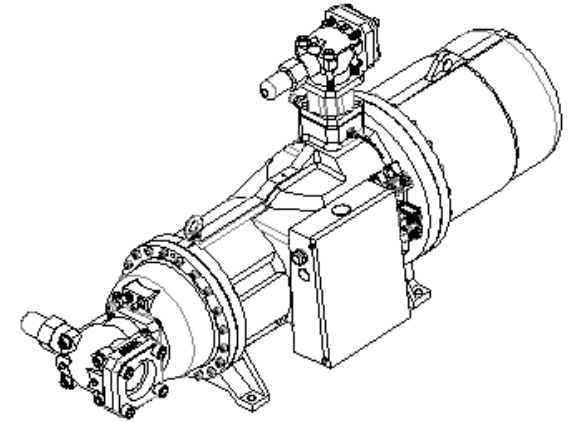
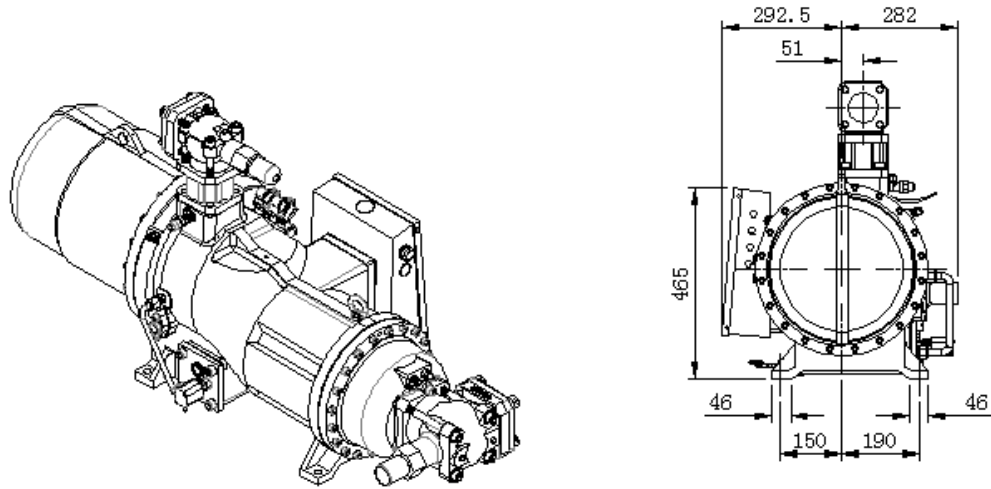

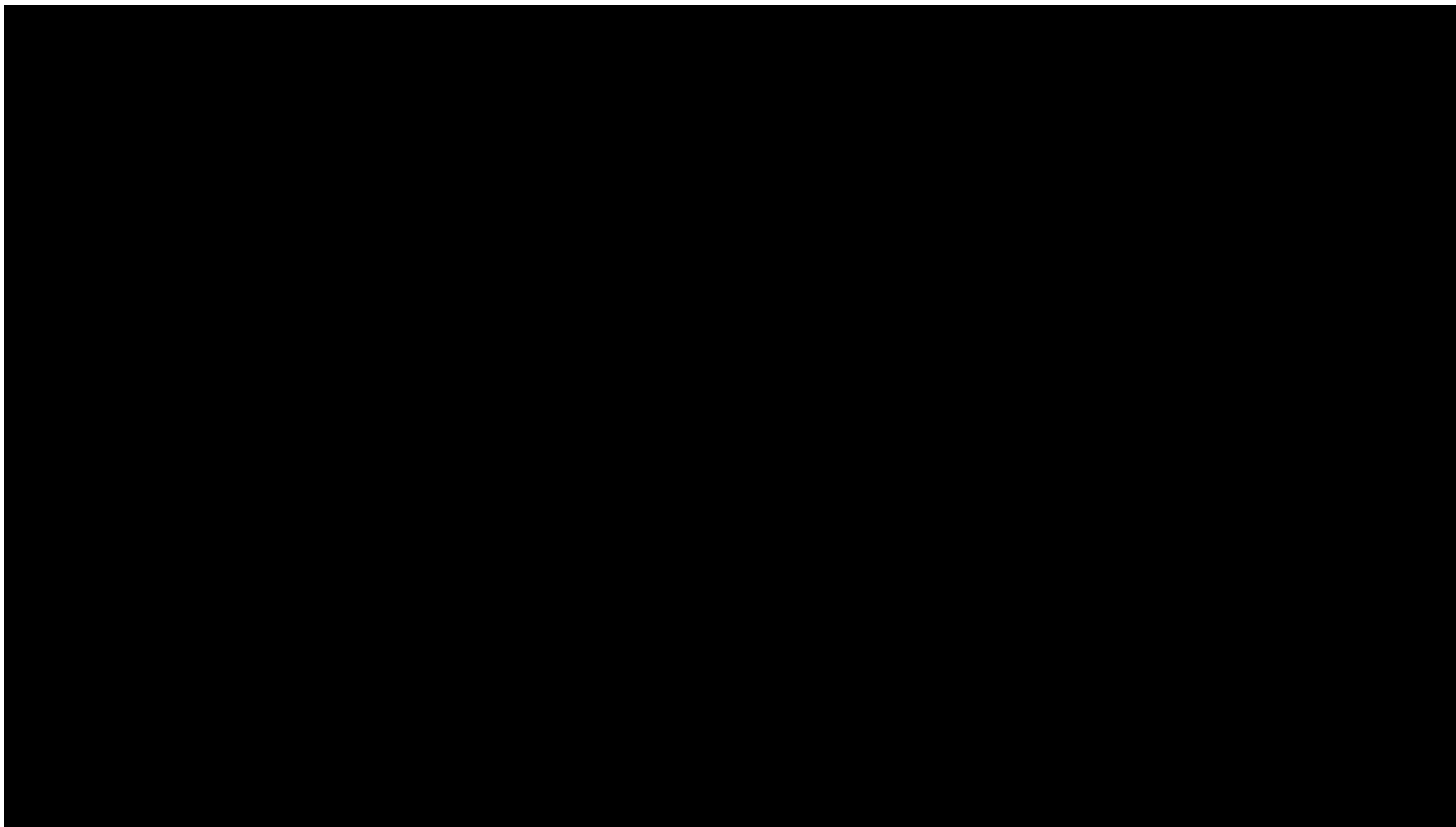

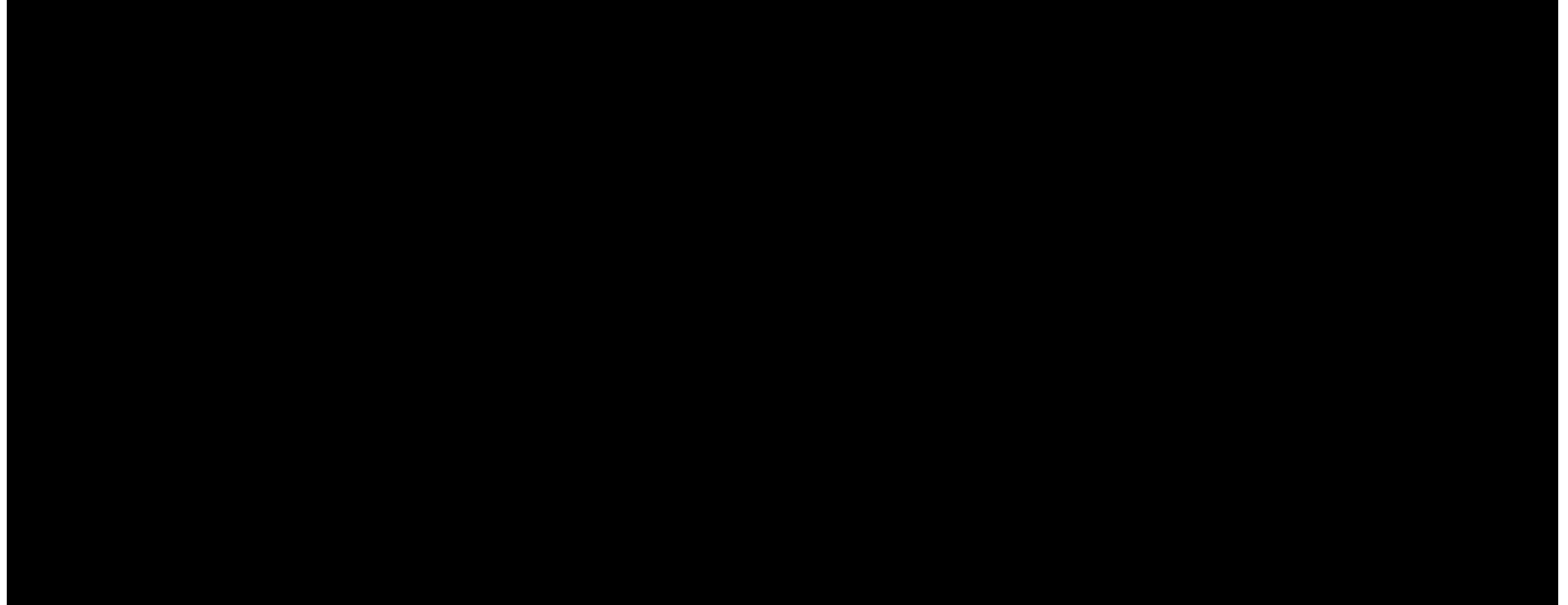
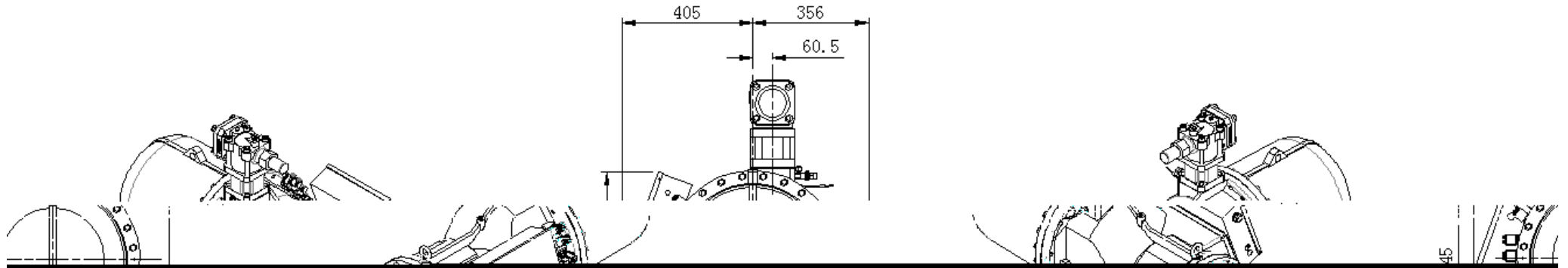

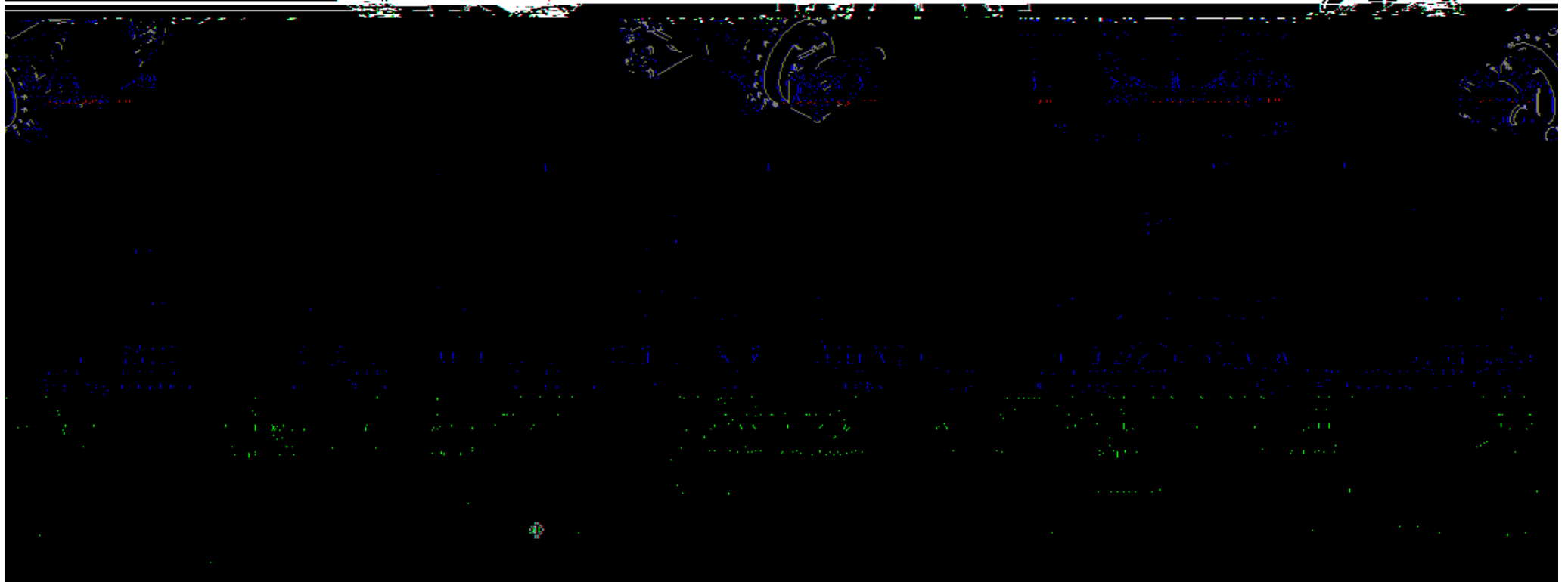
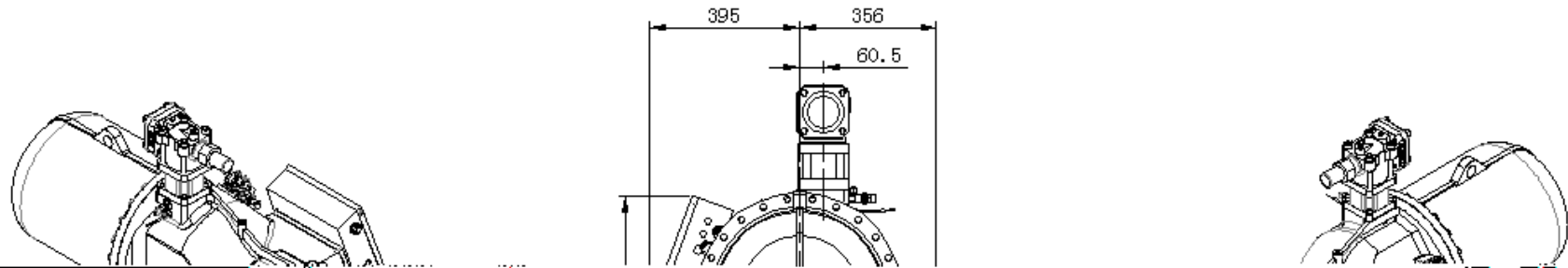

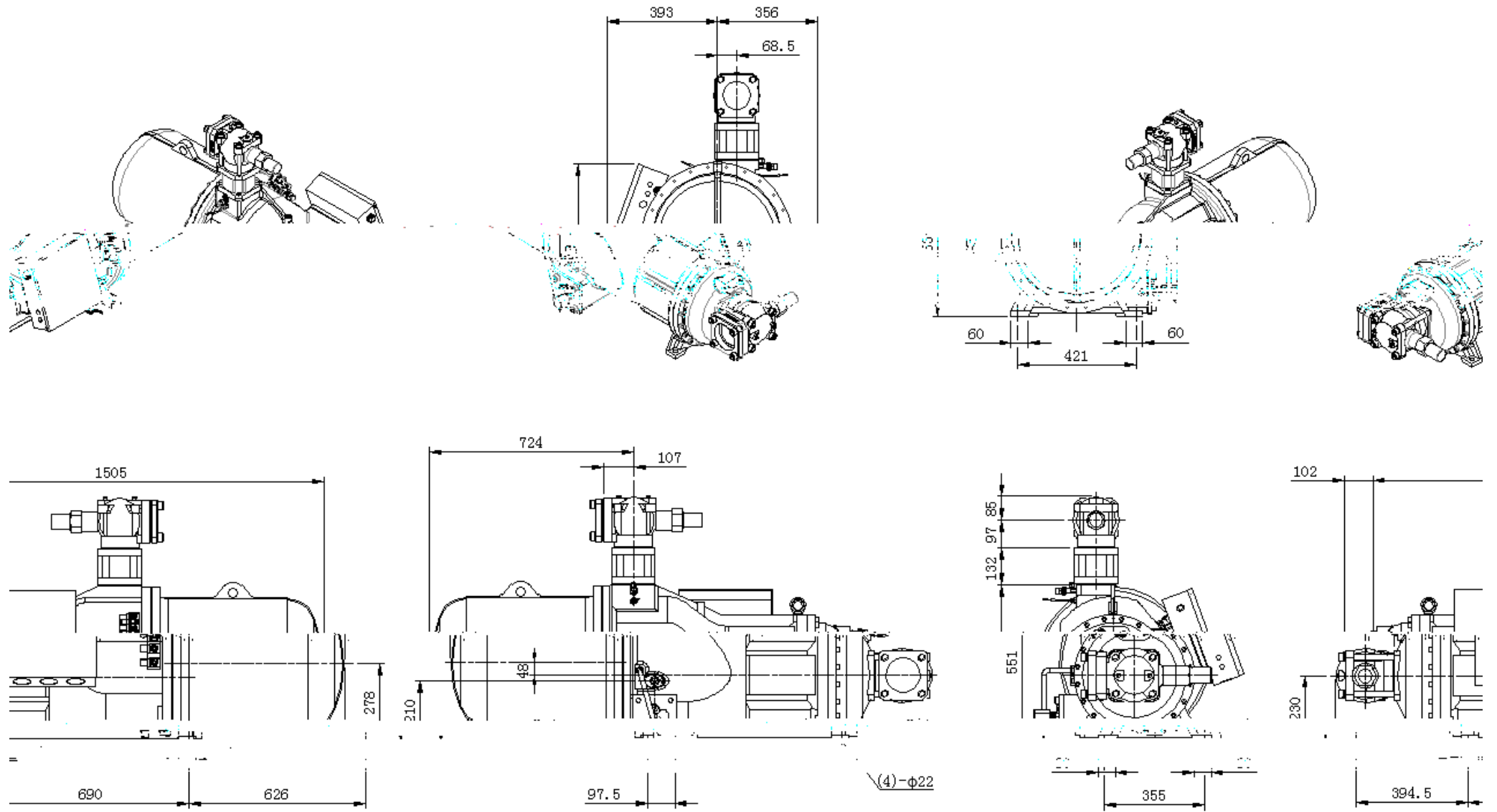

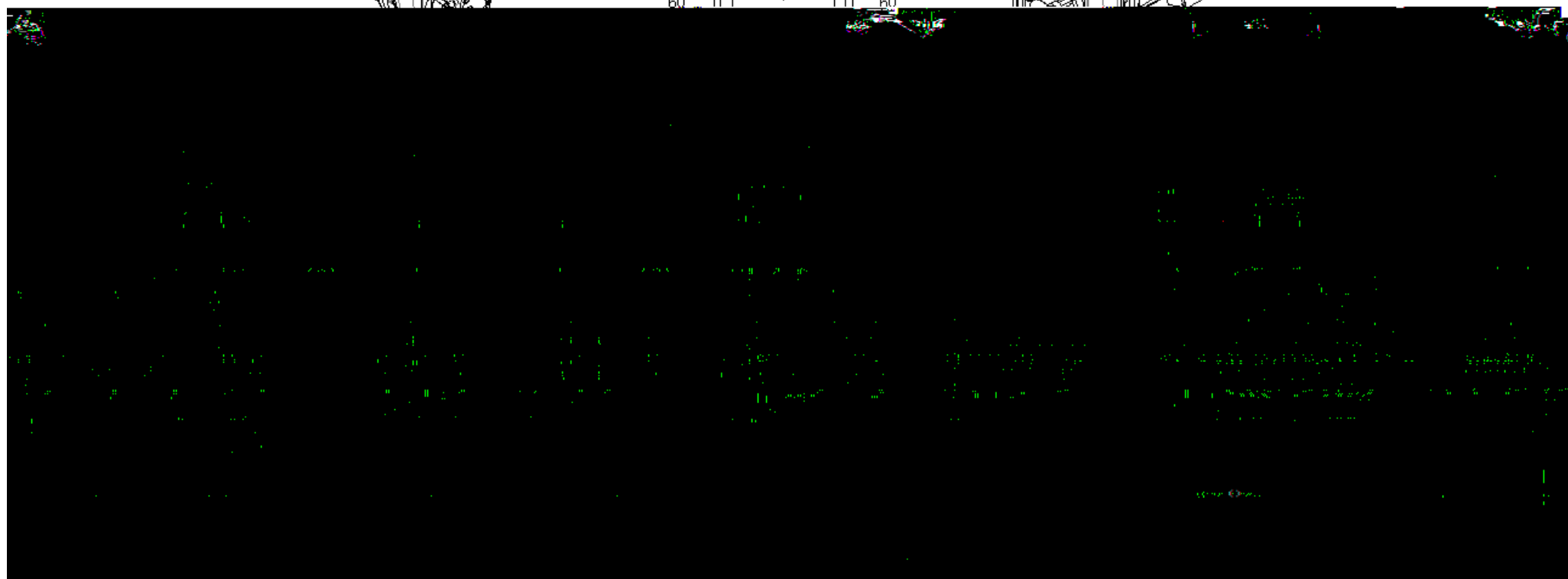
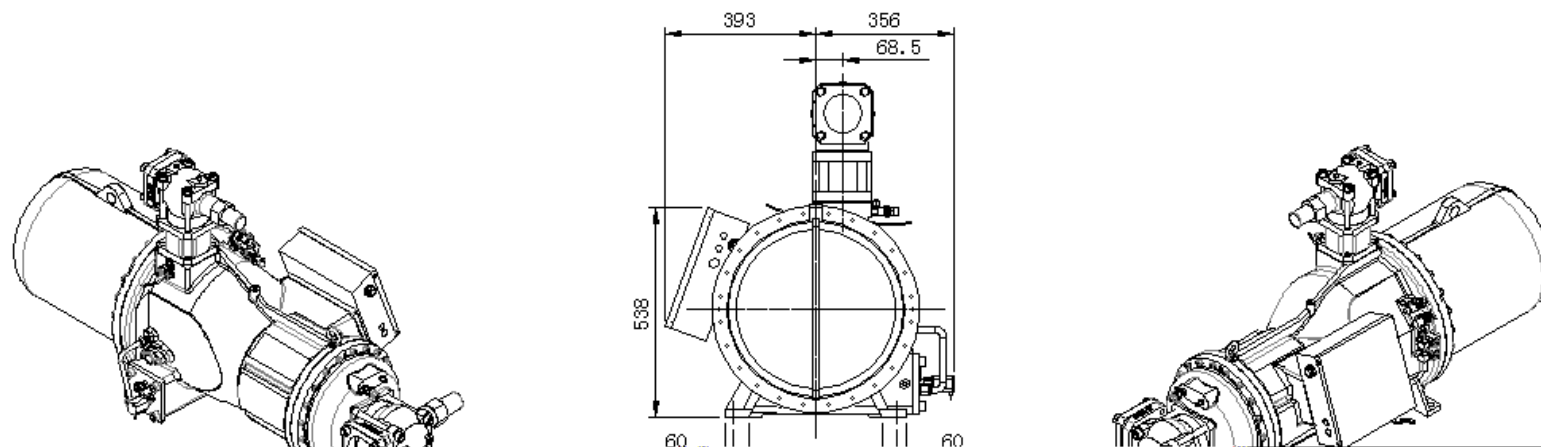

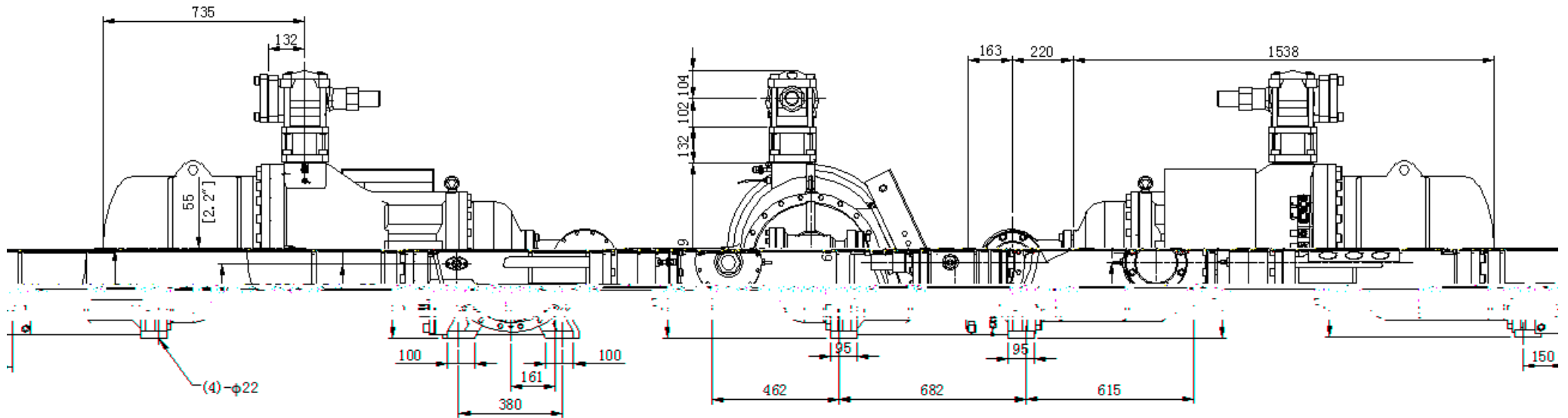
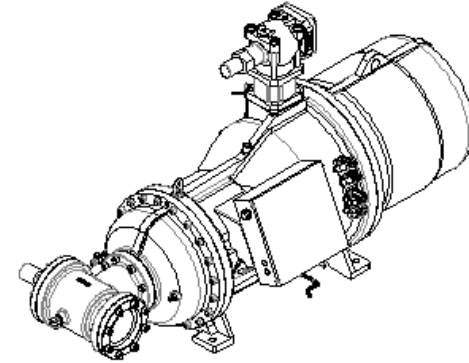
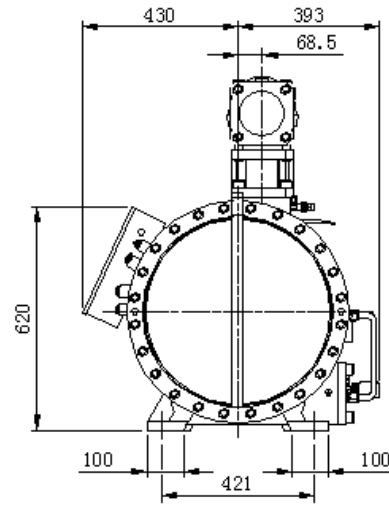
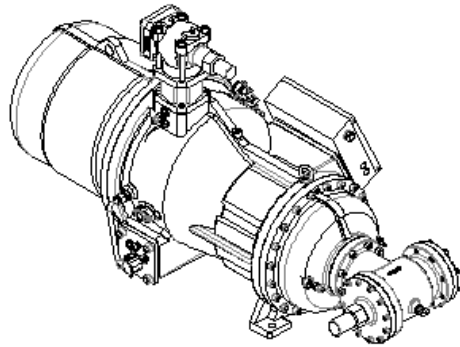

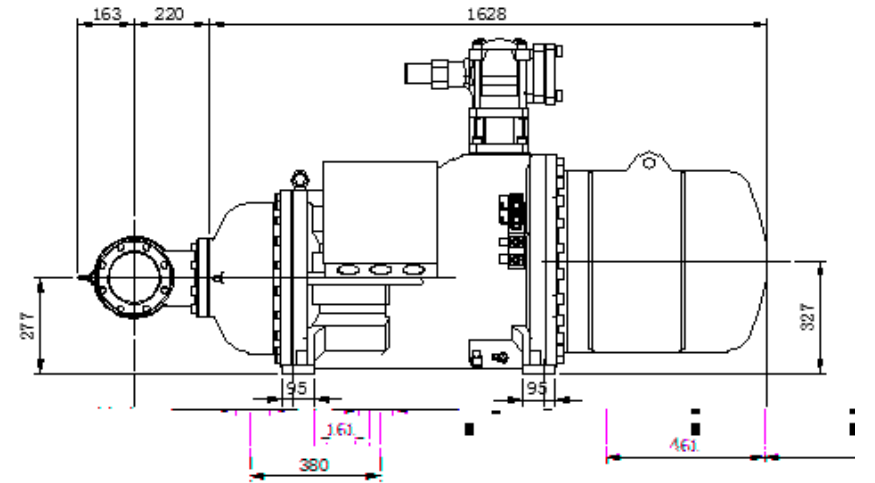
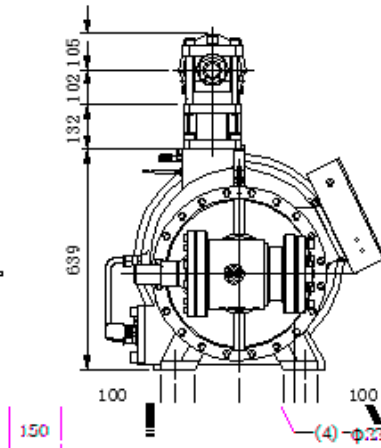
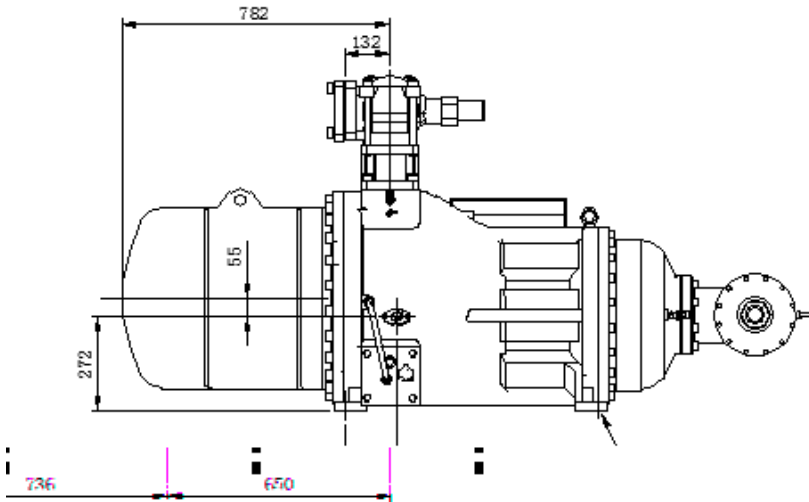
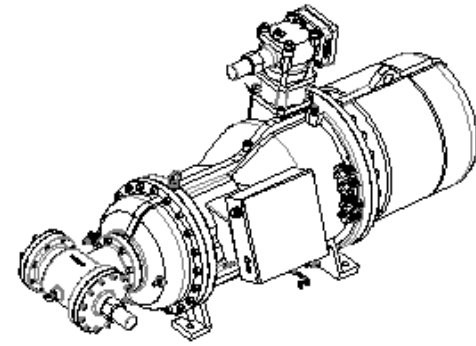
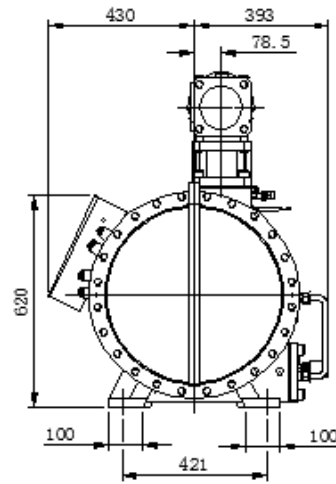
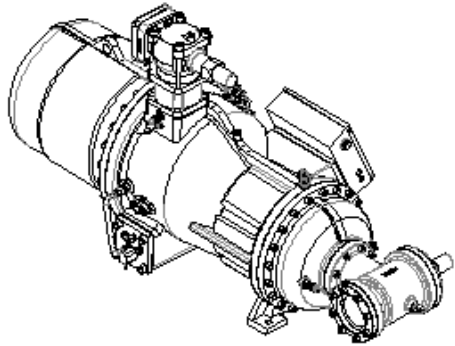

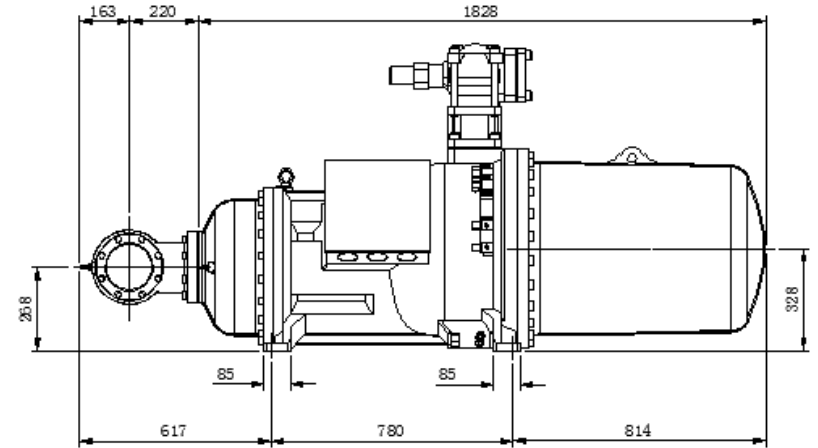
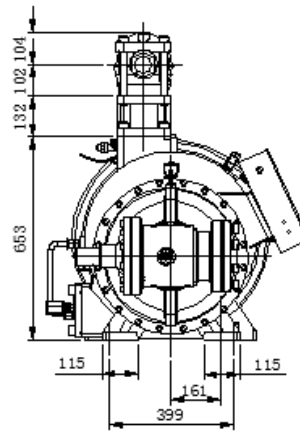
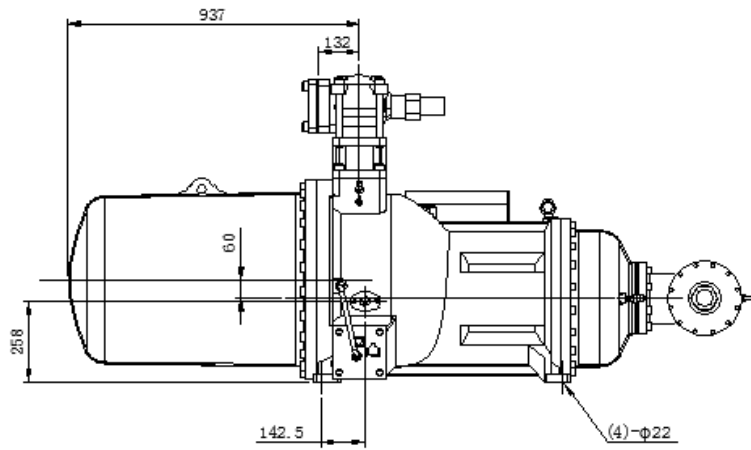
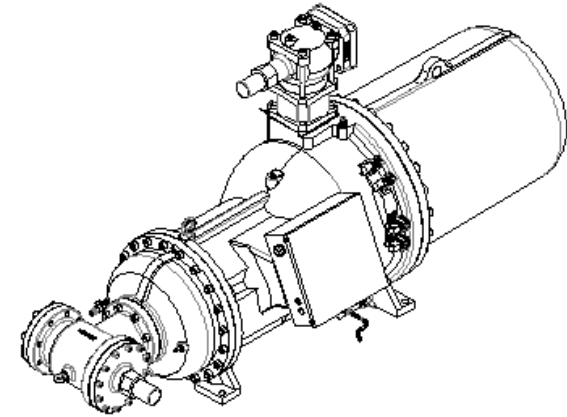
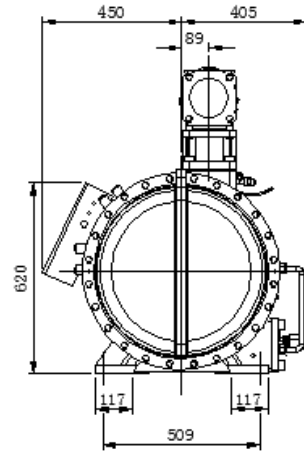
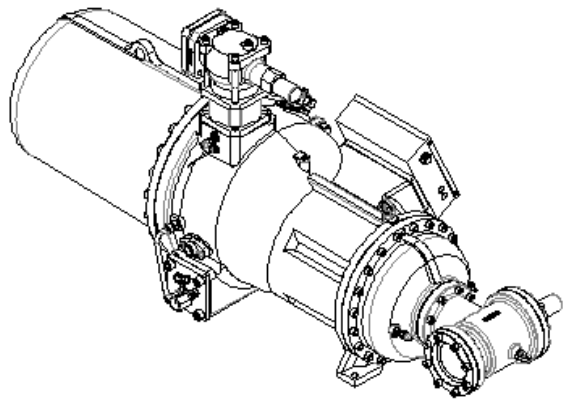

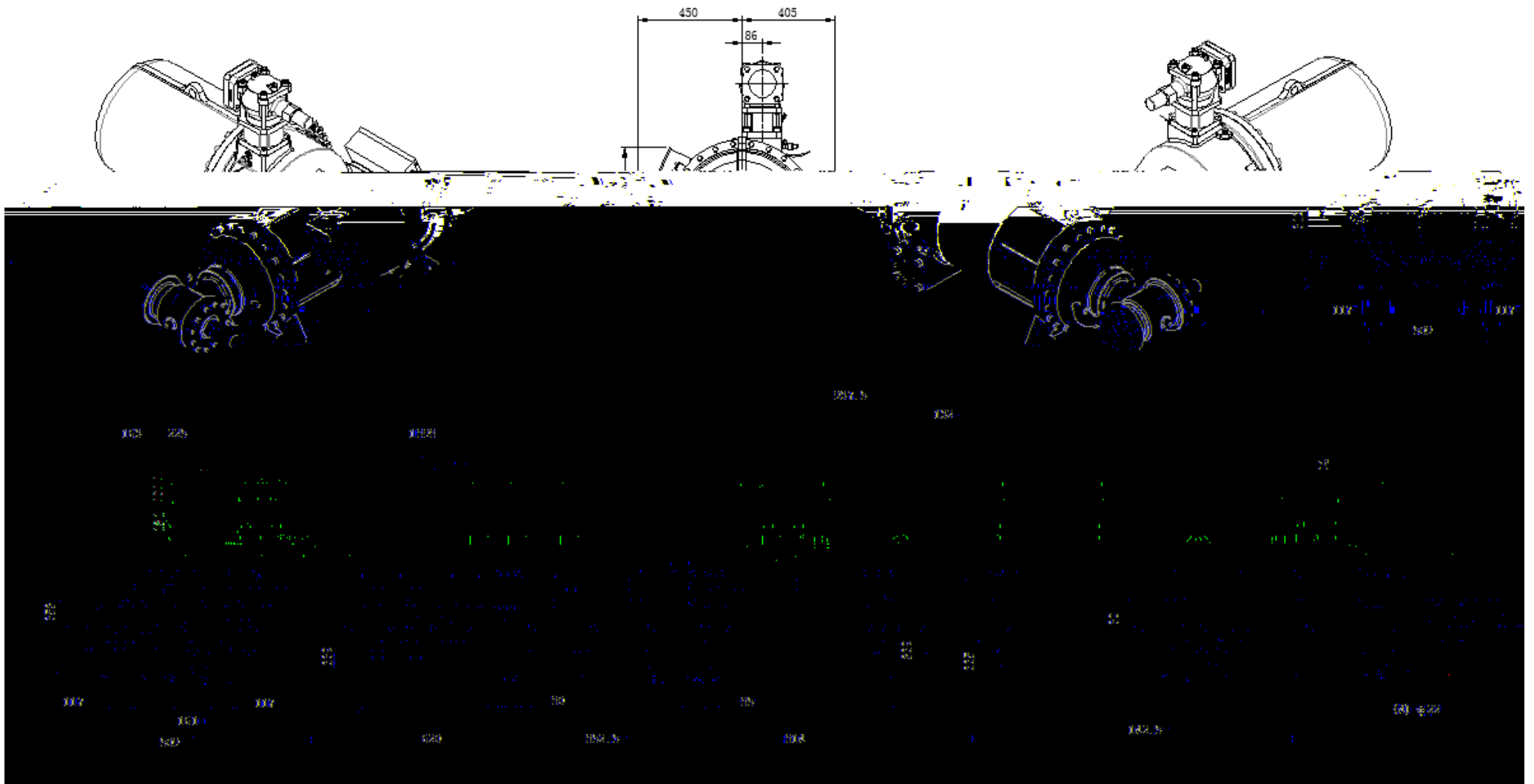

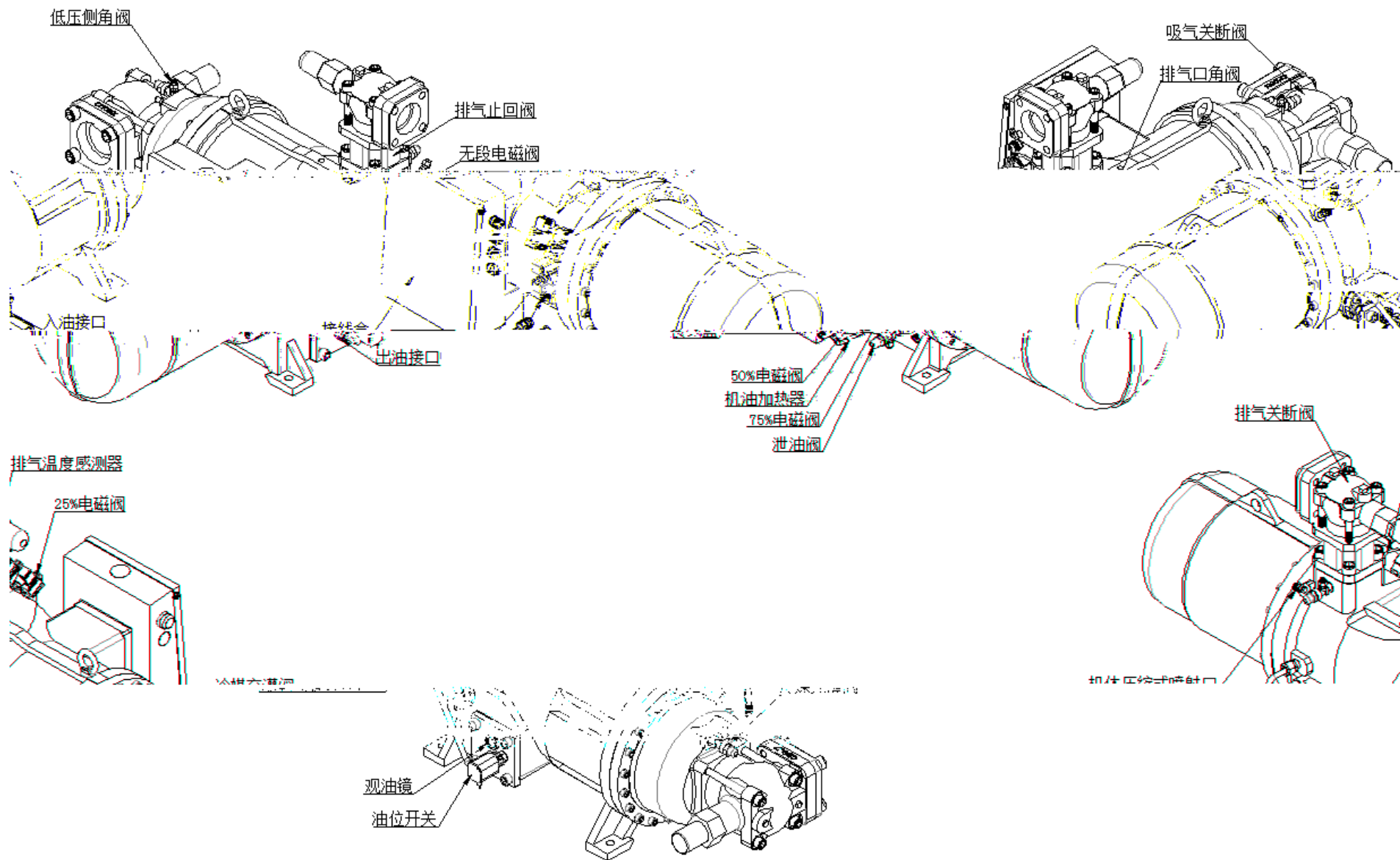

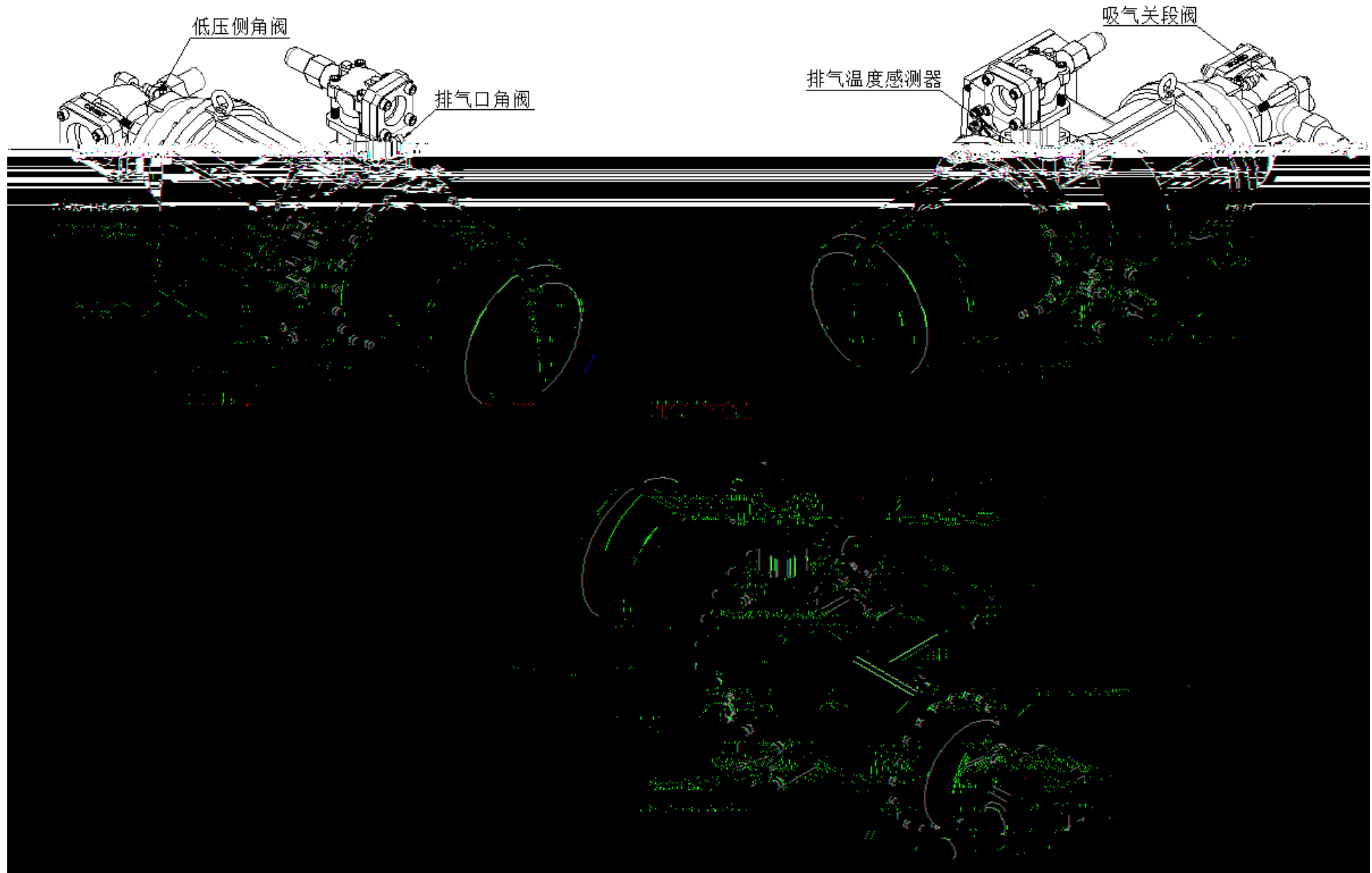

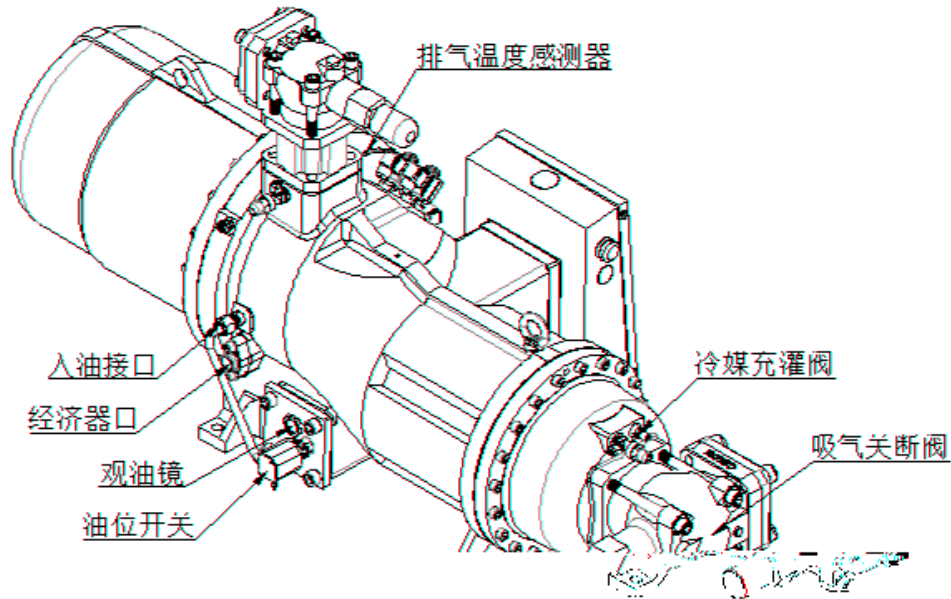
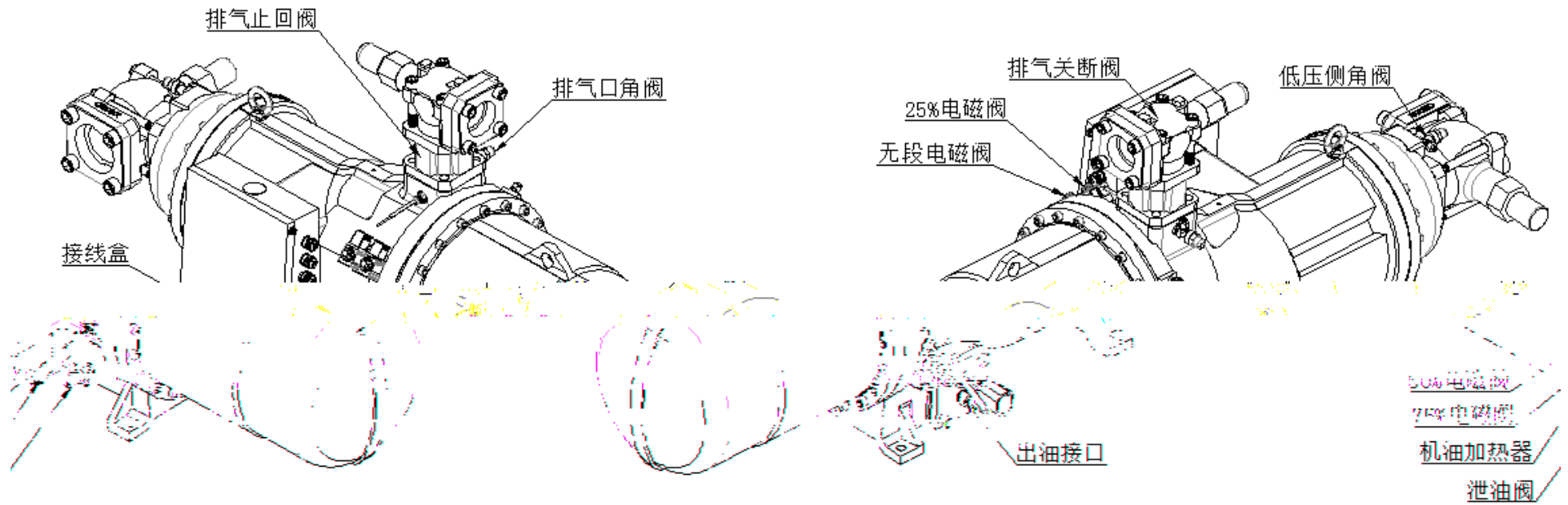

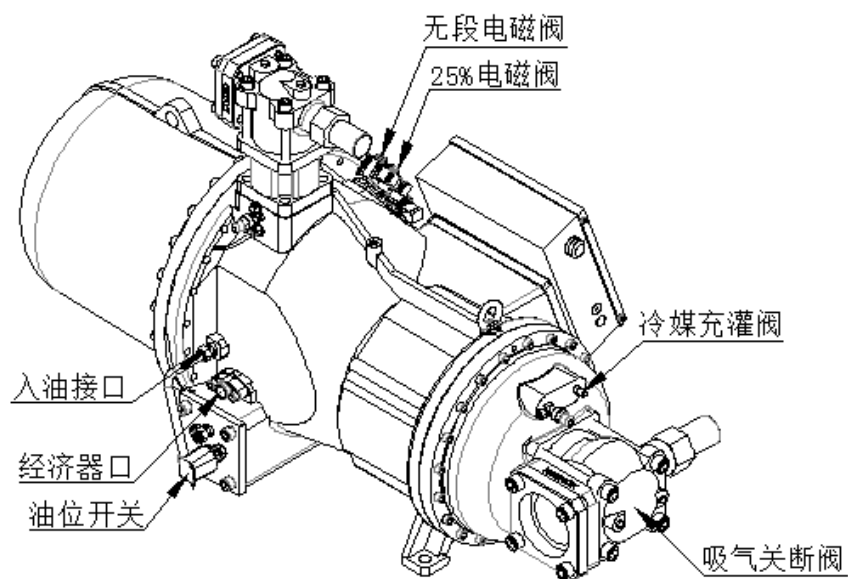
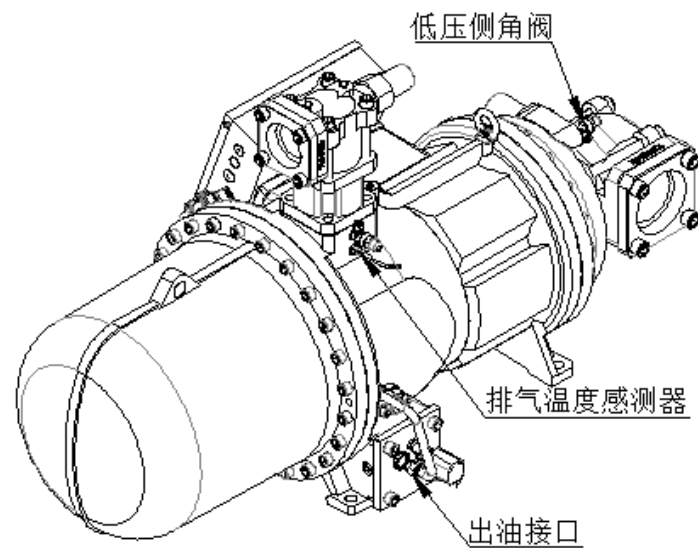
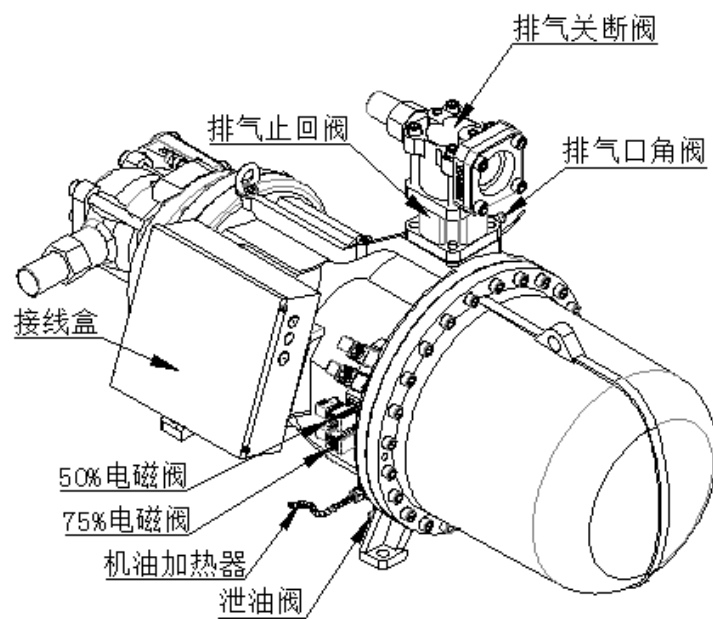

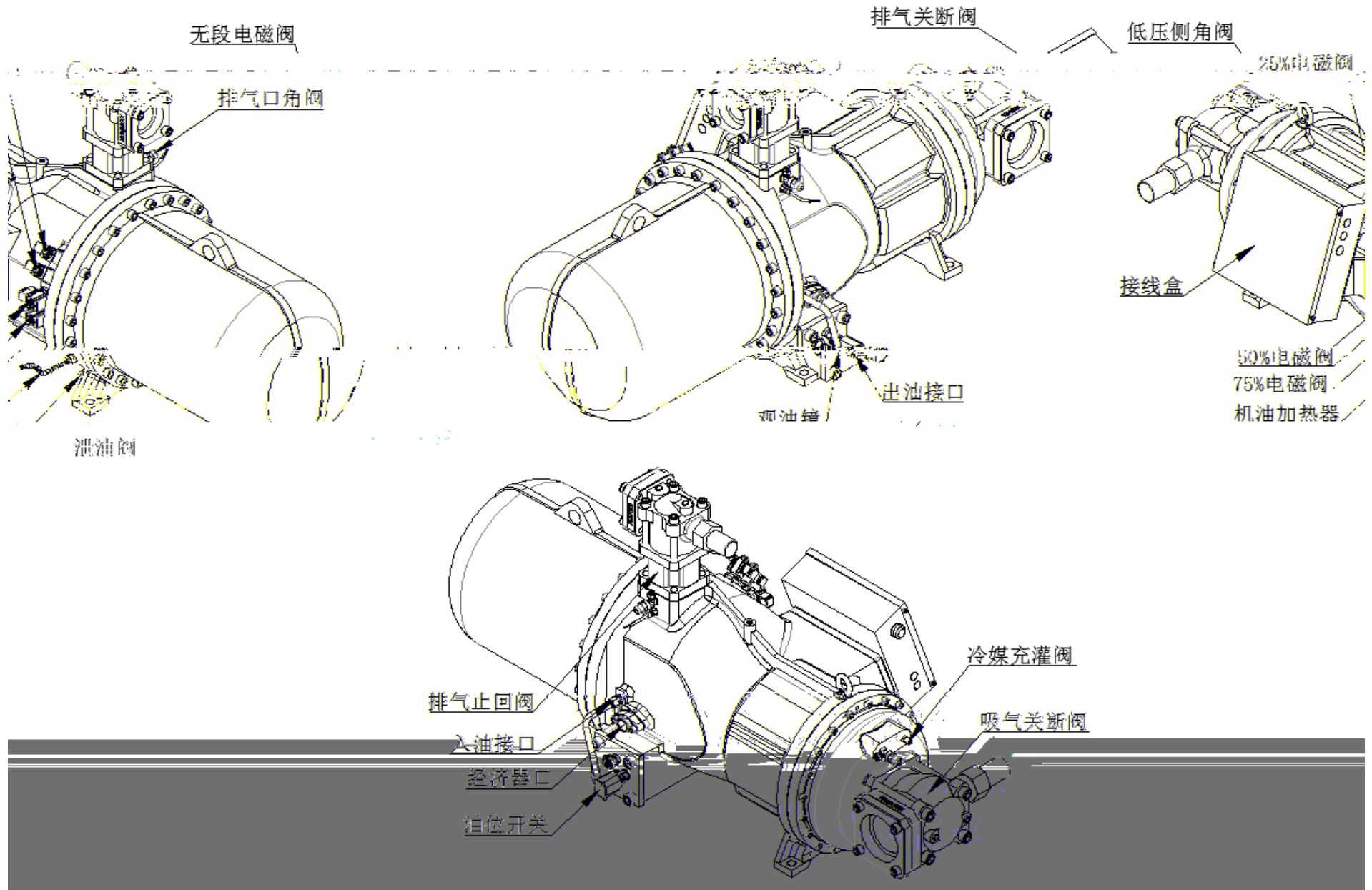

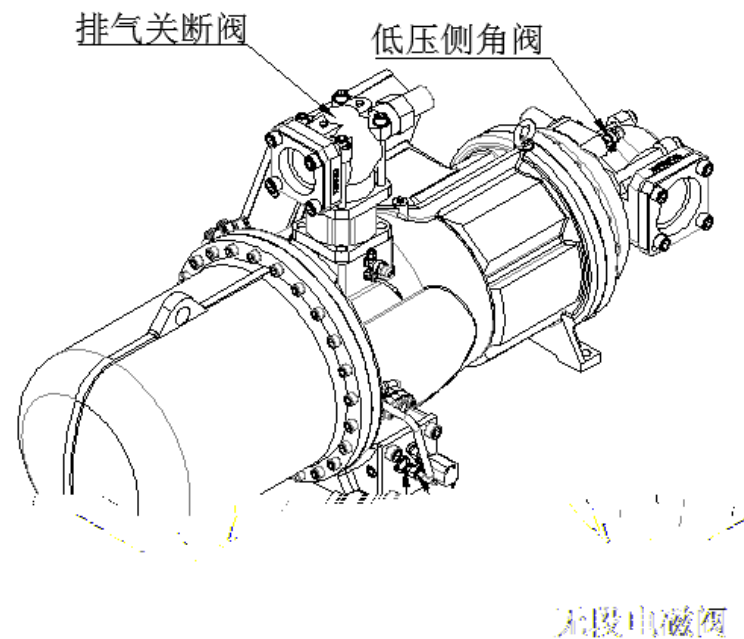
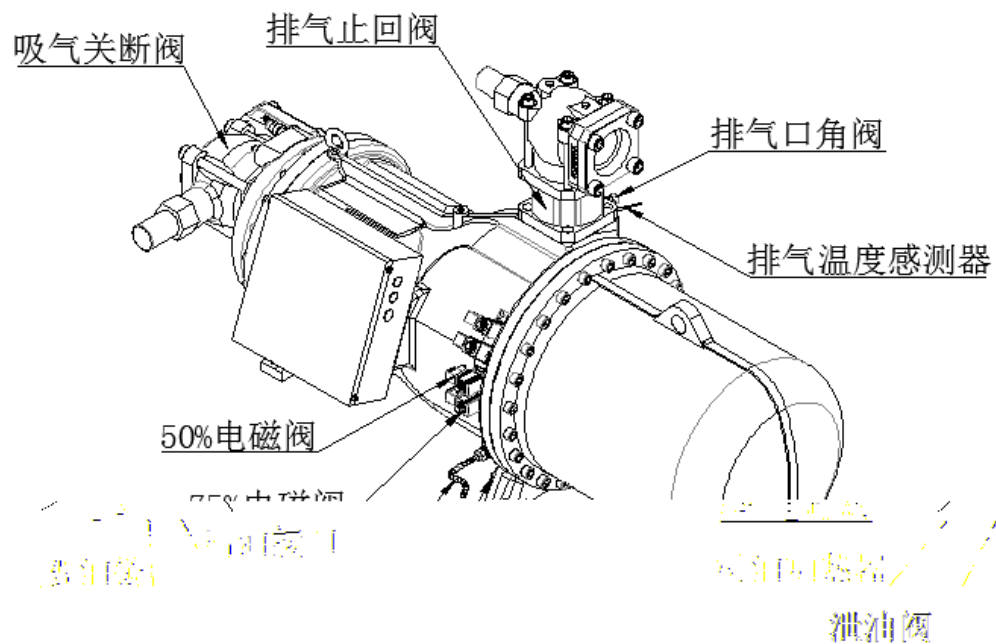

盒

制冷剂充灌阀

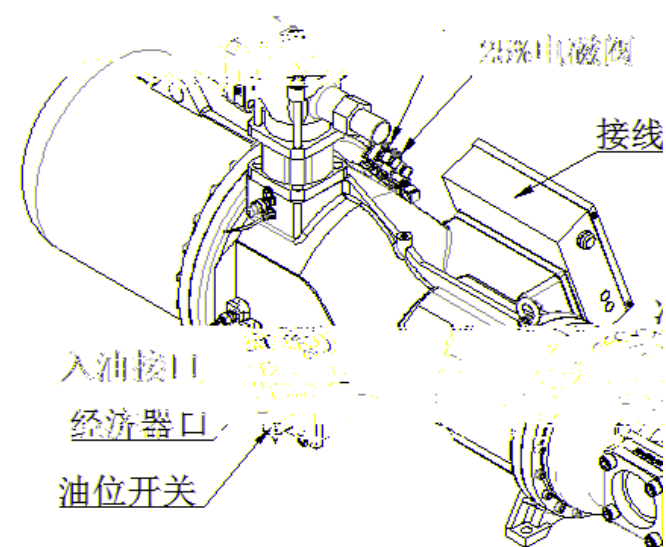

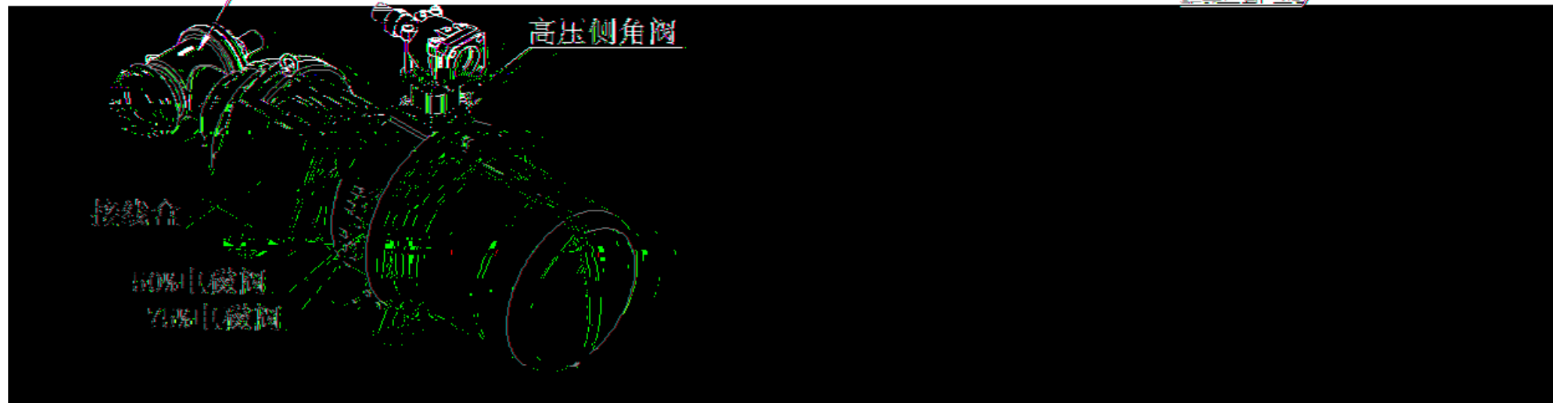
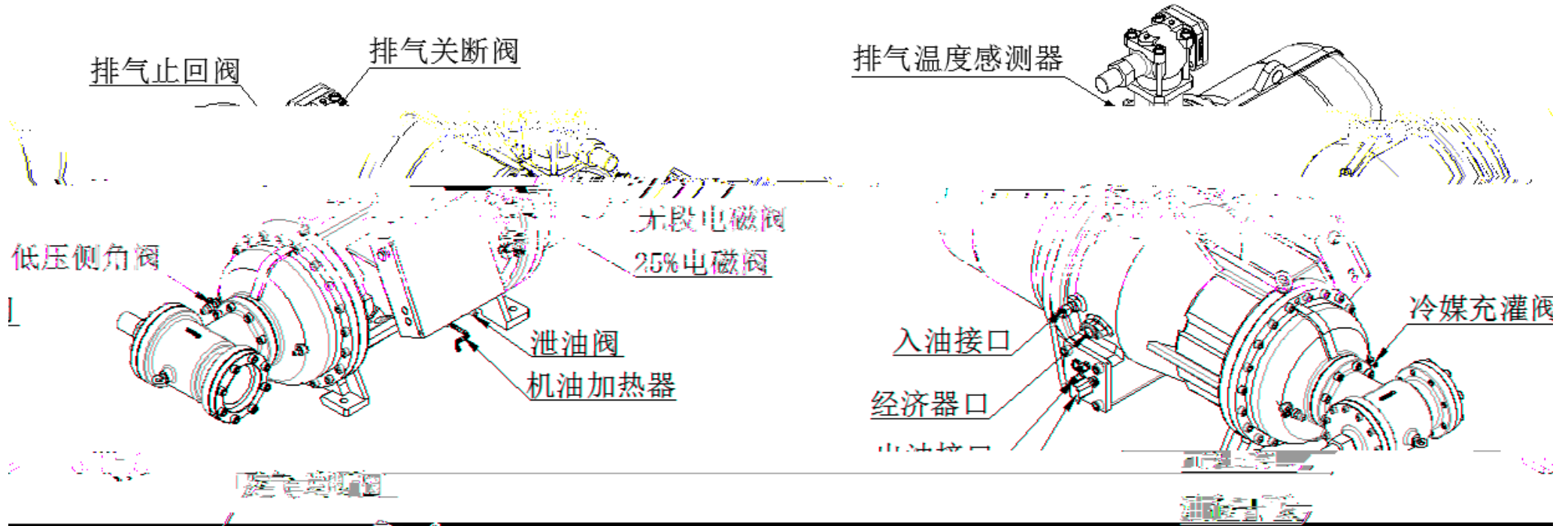

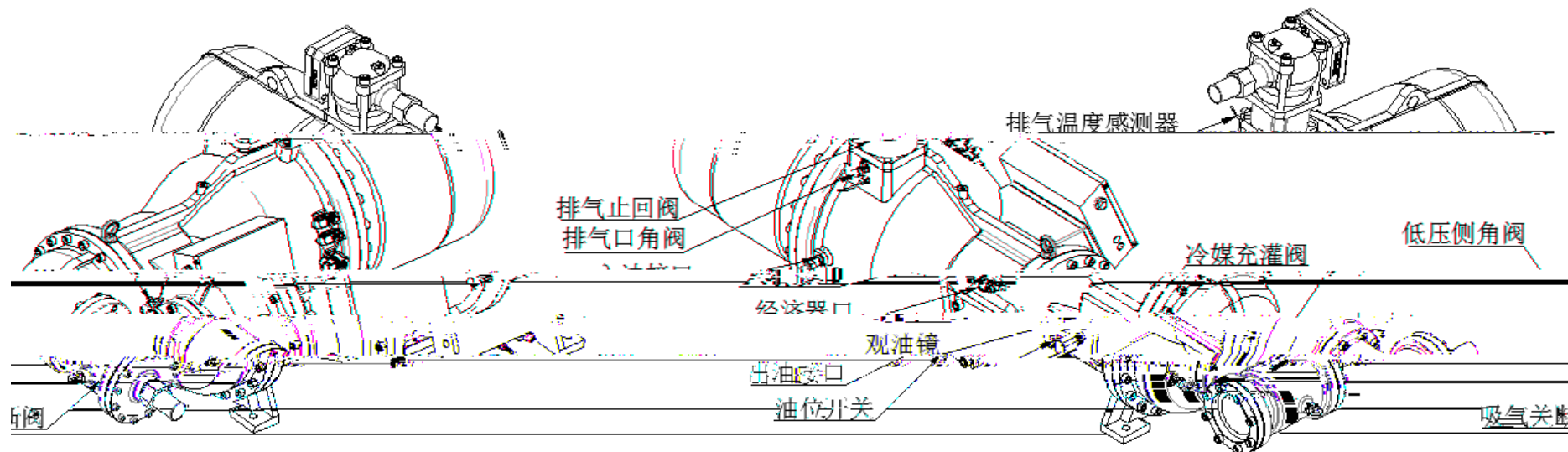

吸气截止阀

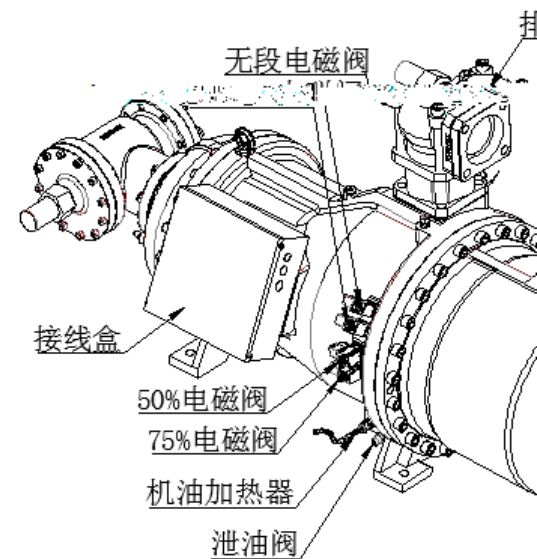
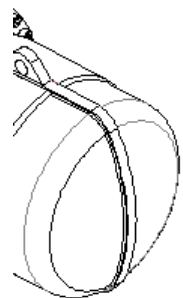

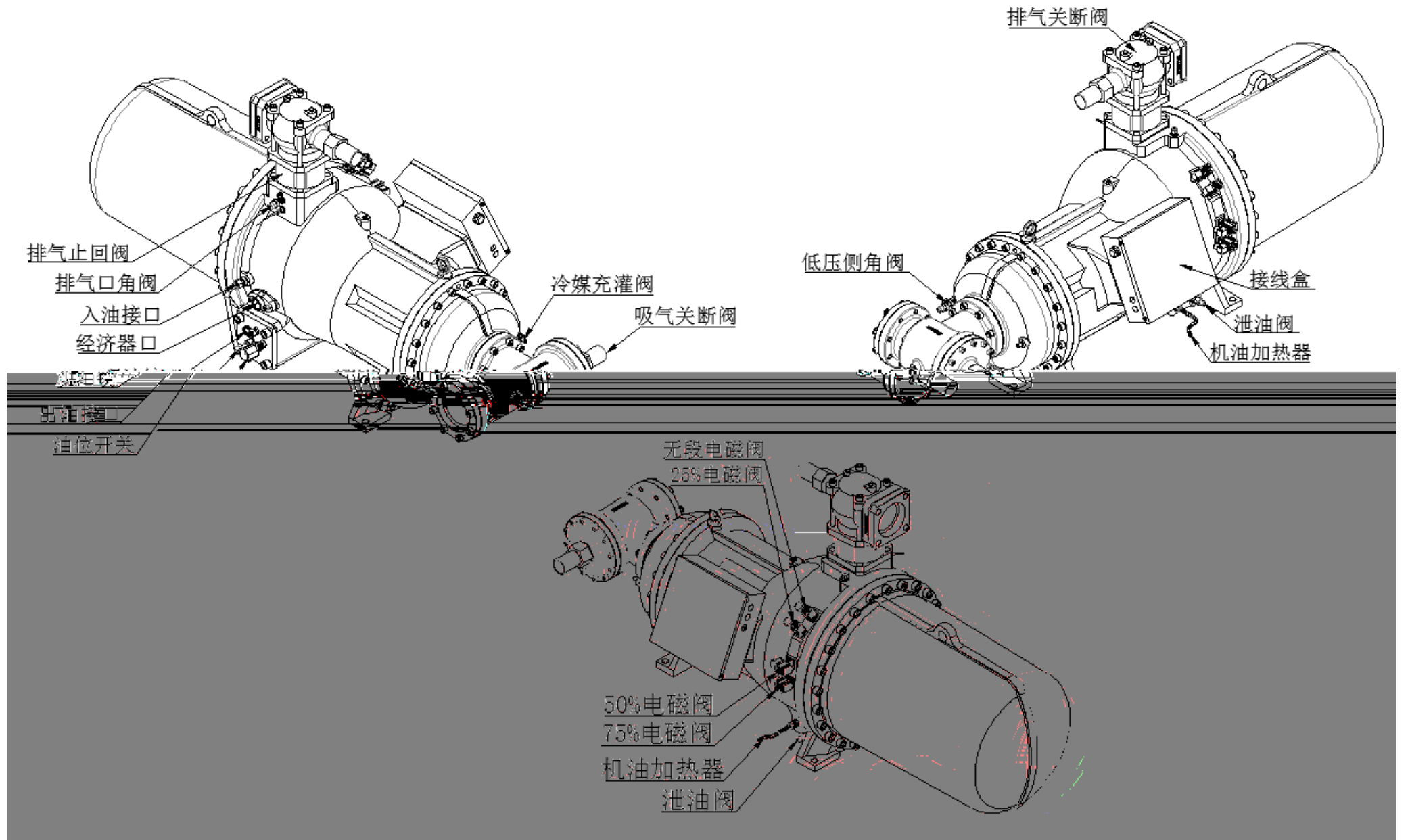

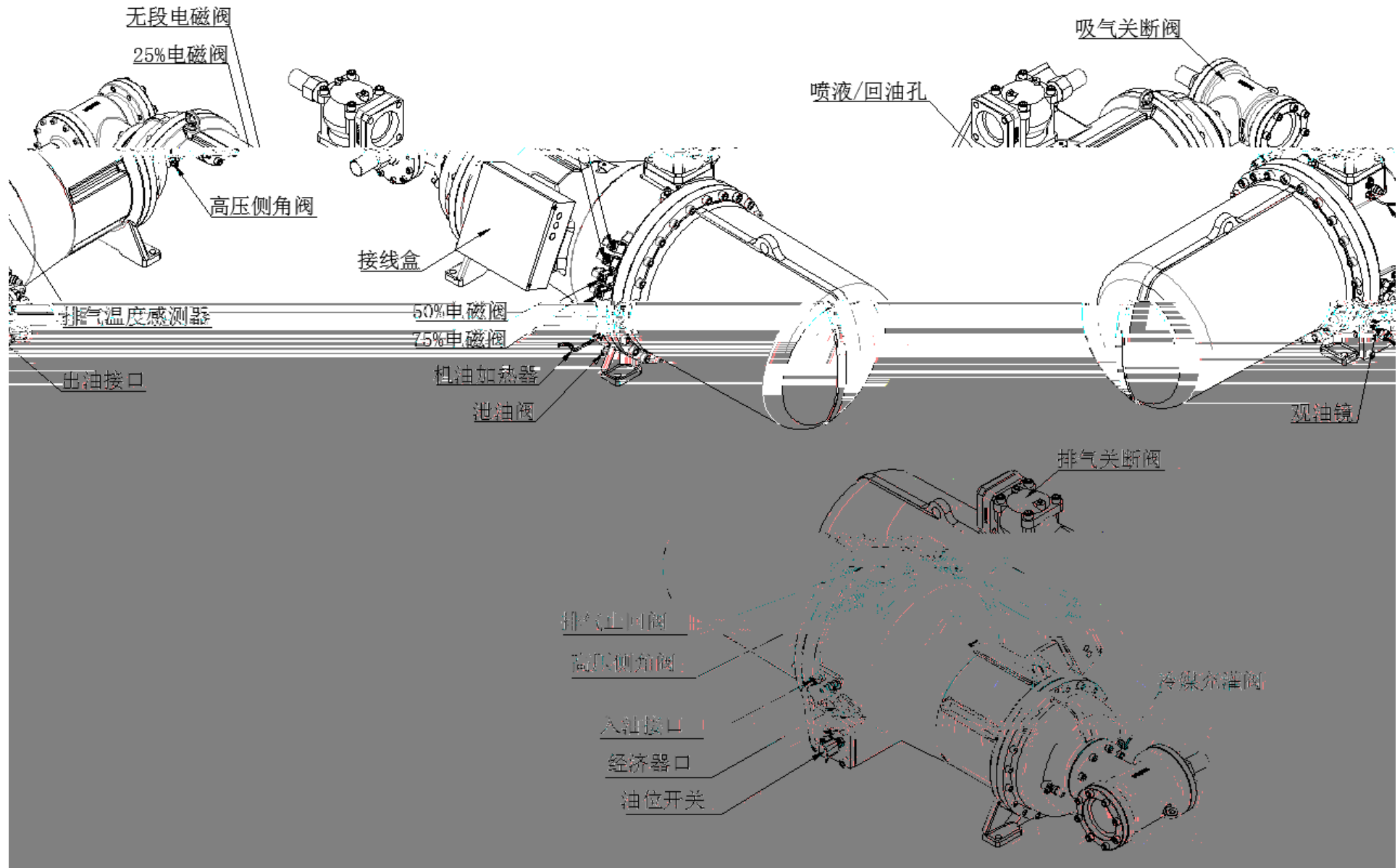

RE-230~1150 吸排气法兰、套管配置								
机型	排气/吸气口	配管材质与尺寸		法兰套管尺寸				
				A	B	C	D	E
RE-230 RE-260 RE-300	排气口	铜 钢	2 1/8"	50	90	30	54.3	65